

DESCRIPTION:

“EL” model valve is the hydraulic control valve operated by line pressure and designed to ensure opening/closing process by means of built-in 3/2-way solenoid pilot valves controlled remotely with electric signal. Electric signal for solenoid pilot valves is ensured by means of a control device, time relay, main switch and PLC control units etc. Opening/ Closing process may be realized easily thanks to manual control on solenoid pilot valve. Depending on desire, 24V AC 50Hz/60Hz or 12V DC, 9V DCLATCH and 12V DC latch normally open (N.O.) or normally closed (N.C.) solenoid coils may be used on main valve.

MAIN CONTROL SYSTEM COMPONENTS:

- 1) Main Valve
- 2) Ball Valve
- 3) Finger Filter
- 4) 3/2 Solenoid Valve N.O Sizes: 1 ½”-5” (PN16-25)
3/2 Solenoid Valve N.O Sizes: 1 ½”-6” (PN10)
- 5) 3 Way Selector Valve
AR3 (1 ½”-5”)
AR6 (6”-12”)
- 6) Relay+N.C Solenoid Valve (Sizes: 6”-12”)

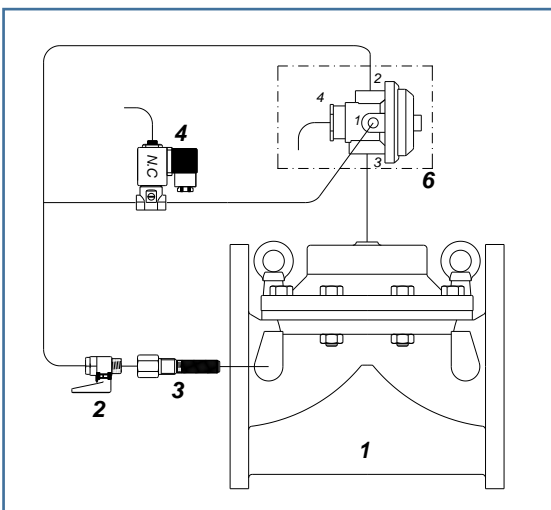
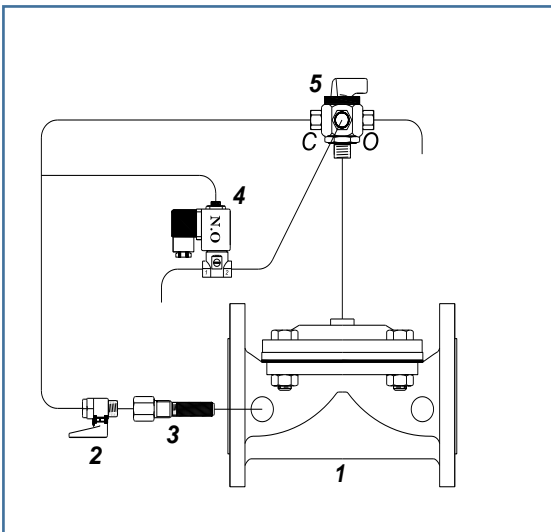

**63EL-64EL-66EL-67EL
Solenoid Control Valve**

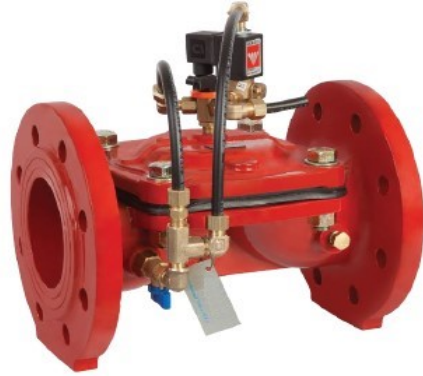

TECHNICAL SPECIFICATIONS:

General Specifications	
Pressure Class	PN10-PN16-PN25
Working Temperature	(-10) - (80 °C)
Size Range	1 ½” – 12”
63 Model (PN10-PN16)	2”-2 ½”-3”-4”
64 Model (PN10-PN16)	2”-2 ½”-3”
66 Model (PN10-PN16)	1 ½”-2”-2 ½”-323”-3”
67 Model (PN10)	1 ½” ---- 6”
67 Model (PN16-PN25)	1 ½” ---- 12”
Main Valve Type	Diaphragm Actuated Diaphragm Closed Single Chamber
Material Properties	
Body - Cover	Ductile Iron
Diaphragm	Reinforced NaturalRubber(Standard) EPDM (optional)
Internals	Stainless Steel, Nylon6,
Coating	Epoxy Powder (Red)
Control System	
3 Way Selector Valve	Performs manual control of the main valve.
Solenoid Valve	24VAC (standard) 12VDC (optional) 9-12VDC Latch (optional)
Fittings	Forged Brass (standard for PN16-25) Stainless Steel (optional) Plastic (standard for PN10)
Tubing	Polyamide (standard for PN10) Reinforced nylon airbrake (standard for PN16-25) Copper (optional) Stainless Steel (optional)
Connection	
Flanged (67 series)	TS EN 1092/2 (standard) ANSI Class 150 (optional)
Threaded (66 series)	BSP (standard) – NPT (optional)
Coupling (63 series)	
Angle Threaded (64 series)	BSP (standard) – NPT (optional)

600 SERIES

DIMENSIONS:

Model 67						
Size		H	C	L	A,B	
inch	mm	mm	mm	mm	mm	mm
1 ½	40	154	454	200	375	
2	50	154	454	200	383	
2 ½	65	162	462	214	393	
323	80*50	160	460	215	400	
3	80	182	482	291	400	
4	100	195	495	305	418	
5	125	204	504	369	435	
6	150	325	625	403	450	
8	200	400	700	494	480	
10	250	463	763	611	513	
12	300	488	788	609	543	

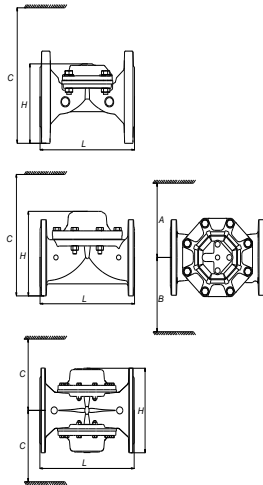

Model 66						
Size		H	C	L	D	A,B
inch	mm	mm	mm	mm	mm	mm
1 ½	40	87	387	161	66	375
2	50	108	408	182	82	383
2 ½	65	112	412	216	93	393
323	80*50	120	420	220	110	400
3	80	125	425	323	110	400

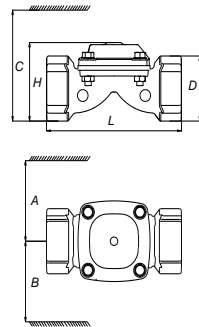

Model 63						
Size		H	C	L	D	A,B
inch	mm	mm	mm	mm	mm	mm
2	50	102	402	185	61	383
2 ½	65	108	408	218	76	393
3	80	125	425	308	89	400
4	100	139	439	313	114	418

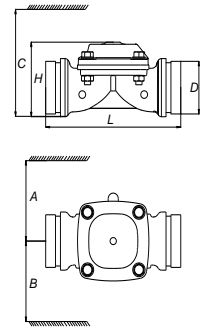

Model 64						
Size		H	C	L	D	A,B
inch	mm	mm	mm	mm	mm	mm
2	50	135	300	130	80	383
2 ½	65	163	300	163	93	393
3	80	223	300	212	110	400

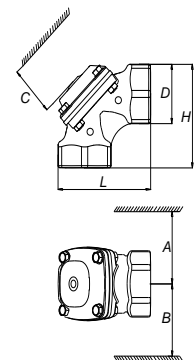

QUICK SIZING:

- Maximum recommended flow velocity for continuous operation 5.5m/s.

Valve Size	mm	40	50	65	80-50-80	80	100	125	150	200	250	300
	inch	1½	2	2½	323	3	4	5	6	8	10	12
Kv	m³/h @ 1 bar	35	50	50	50	130	200	200	450	800	1250	1800
Cv	gpm @ 1 psi	45	60	60	60	150	231	231	520	925	1450	2080
Maximum Flow Continuance	m³/h	25	39	39	39	100	156	156	350	622	972	1400
	gpm	110	171	171	171	438	685	685	1541	2739	4279	6162
Maximum Flow Intermittent	m³/h	50	78	78	78	199	311	311	477	848	1325	1909
	gpm	219	342	342	342	876	1369	1369	2101	3735	5836	8403

FLOW CHART:

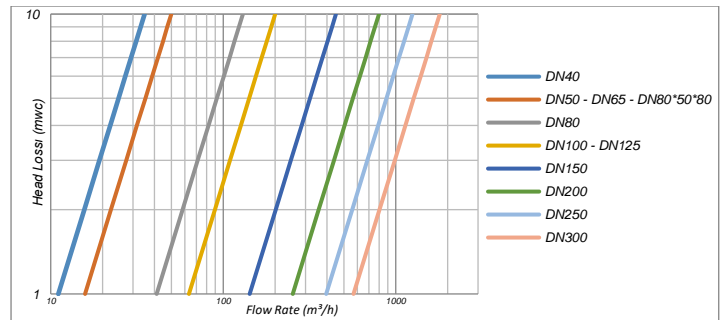

TYPICAL INSTALLATION:

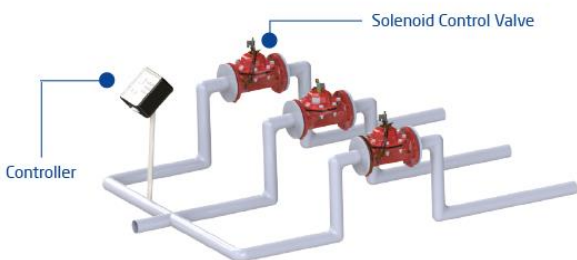

Solenoid Controlled Valves can be used with a local control unit or advanced automation systems.